

Addendum No. 1 to IFB 17-52



CITY OF SOMERVILLE, MASSACHUSETTS
Department of Purchasing
JOSEPH A. CURTATONE
MAYOR

To: All Parties on Record with the City of Somerville as Holding IFB 17-52,
Hoyt Sullivan Park

From: Michael Richards, Assistant Purchasing Director

Date: February 27, 2017

Re: Answer questions posed at pre-bid site visit, update electrical drawings, attach pre-bid
site visit attendance list

Addendum No. 1 to IFB 17-52

Please acknowledge receipt of this Addendum by signing below and including this form in your proposal package. Failure to do so may subject the proposer to disqualification.

The optional pre-bid site visit was held on Friday February 24th. This addendum serves to post all questions and answers from the site visit and include the attendance list. The electrical drawings have also been updated and are included herein.

NAME OF COMPANY / INDIVIDUAL: _____

ADDRESS: _____

CITY/STATE/ZIP: _____

TELEPHONE/FAX/EMAIL: _____

SIGNATURE OF AUTHORIZED INDIVIDUAL: _____

ACKNOWLEDGEMENT OF ADDENDA:

Addendum #1 _____ **#2** _____ **#3** _____ **#4** _____

Addendum No. 1 to IFB 17-52

Questions from Prospective Bidders from Pre-Bid Site Visit

1) Q. The trees between the basketball court and the property line parallel to the train tracks need to come down. Do the stumps need to be removed?

A. Per the notes on L1.0, stumps can remain in place as long as they don't conflict with new footings or structure.

2) Q. Does the MBTA want prequalification in 'right of way' for work near the tracks? Any machine that comes in to work in the area could influence the track and has to be accounted for, correct?

A. The City is submitting the MBTA's License of Entry application, which when approved should allow the City's selected vendor to work on City property adjacent to the MBTA property. The MBTA has not requested any pre-approval/ prequalification of vendors. As discussed in the Bid package, the vendor will be required to carry additional insurance and attend MBTA's Roadway Workers' Protection training course. Per the plans, the work on the slope shall be conducted by hand. Tree removals may be performed with a crane located in the playground above the slope. Vendors will familiarize themselves with the license requirements at: <https://www.mbtarealty.com/licenses/>

3) Q. There is a neighbor with a large tree and a fence in the abutting property. Are they aware of and supportive of the project?

A. All adjacent properties are aware of the project. The middle house with the large tree and fence is owned by a property management company. The property to its right is owned by a gentleman that has created a garden on the park property with a stone wall which is to remain in place. Everything below the wall shall be removed per L1.0.

4) Q. The concrete wall between the park and the private homes will stay?

A. Yes, the concrete wall stays except in where, to meet final existing grade (as shown on L3.1 and L5.1) the height of the wall needs to be reduced by 18". The trees on private property will stay as well. The property manager may contact the contractor for more tree removal, but this work is not part of the scope.

5) Q. Can you speak to the electrical and lighting?

A. The electrical drawings are being reissued as part of this addendum. Lighting scope includes new pedestrian poles and fixtures and new fixtures on existing poles, as well as LED tape lights. See E1.1 and E1.2

6) Q. The water is connected, correct? No excavation in street needed?

A. Correct

Addendum No. 1 to IFB 17-52

7) Q. Is a backflow needed?

A. Yes, see IR1.0 and IR2.0. Backflows and water meters are required in an above ground cabinet.

8) Q. When will the T approve the license for the adjacent site work?

A. The process takes about 45 days. The City submitted the application around 2/14/17. Per the bid package and MBTA License requirements, the license will not be approved until after the MBTA has approved the vendors Insurance certificates. The City expects that the License will be available shortly after the issuance of the vendor's contract.

9) Q. What will be done with the chain link fence above the basketball court?

A. Chainlink backstop above galv steel picket fence shall be removed per L1.0

10) Q. Is there parking nearby?

A. There is no parking on either side of the street outside of the park. Staging will need to be done on site. There is street parking a block away or you may be able to work out a deal with nearby privately-owned lots. As noted in the bid package, the vendor will need to submit a traffic management plan to the City's Traffic and Parking Department before work can proceed.

11) Q. Does the sidewalk come out?

A. Yes, as indicated on L1.0 sidewalk is being removed and replaced with new grading on L3.1. Per the guidelines of the City's Traffic and Parking Office, the vendor will need to supply all appropriate signage to ensure safe pedestrian traffic. Police Details will be required as necessary.

12) Q. The benches are to be removed?

A. Correct, benches, play, furniture – most site features. Exceptions include the Big Belly trash and recycling container, and signage. The see-saw may also be kept and re-used by the City. The Vendor shall meet with the DPW on site to review items to be salvaged.

13) Q. Describe the pruning of trees needed.

A. Pruning shall be done in accordance with specification section 015639.

14) Q. How far around the beech tree are we excavating?

A. No demolition around the beech tree will be required. Helical piers shall be installed as per L7.6

15) Q. Is there no real underdrainage?

Addendum No. 1 to IFB 17-52

A. There is some, all combined. See IR drawings.

16) Q. With the new company in Canada providing the new playground equipment – did they give you a rough idea of the lead time?

A. See specification section 116800 Play Equipment for contact information. Lead time and Pricing shall be readily available from the company. Also note they send a representative to the site during install.

17) Q. Is existing steel picket fence remaining?

A. Yes, except where indicated on the plans for removal adjacent to the overlook.



CITY OF SOMERVILLE, MASSACHUSETTS
Department of Purchasing
JOSEPH A. CURTATONE
MAYOR

BID # IFB 17-52 DATE: 2/24/2017 TIME: 10am

The following individuals were in attendance for a pre-bid meeting for:

Hoyt Sullivan Playground

Name	Company	Email Address	Phone Number
Mike Emanouil	Emanouil Inc.	MEmanouil@Emanouilinc.com	608 672 0166
Kyle Kanuto	Mackay	Kanuto@mackaycompanies.com	781-760-1885
Esleban Montoya	Mackay	emontoya@mackaycompanies.com	781-760-1885
Jeff Sacco	JNS Sacco, Inc.	js@sacco.com	617-489-1819
Rod Bedard	Moisture Shield Decking	rodbedard@csnet.com	860-949-5032

Under the penalties of perjury, the above list represents the names of all bidders in attendance at the pre-bid meeting and I declare that said list is a complete and accurate list of attendees.



Michael Richards
Assistant Director

Witness

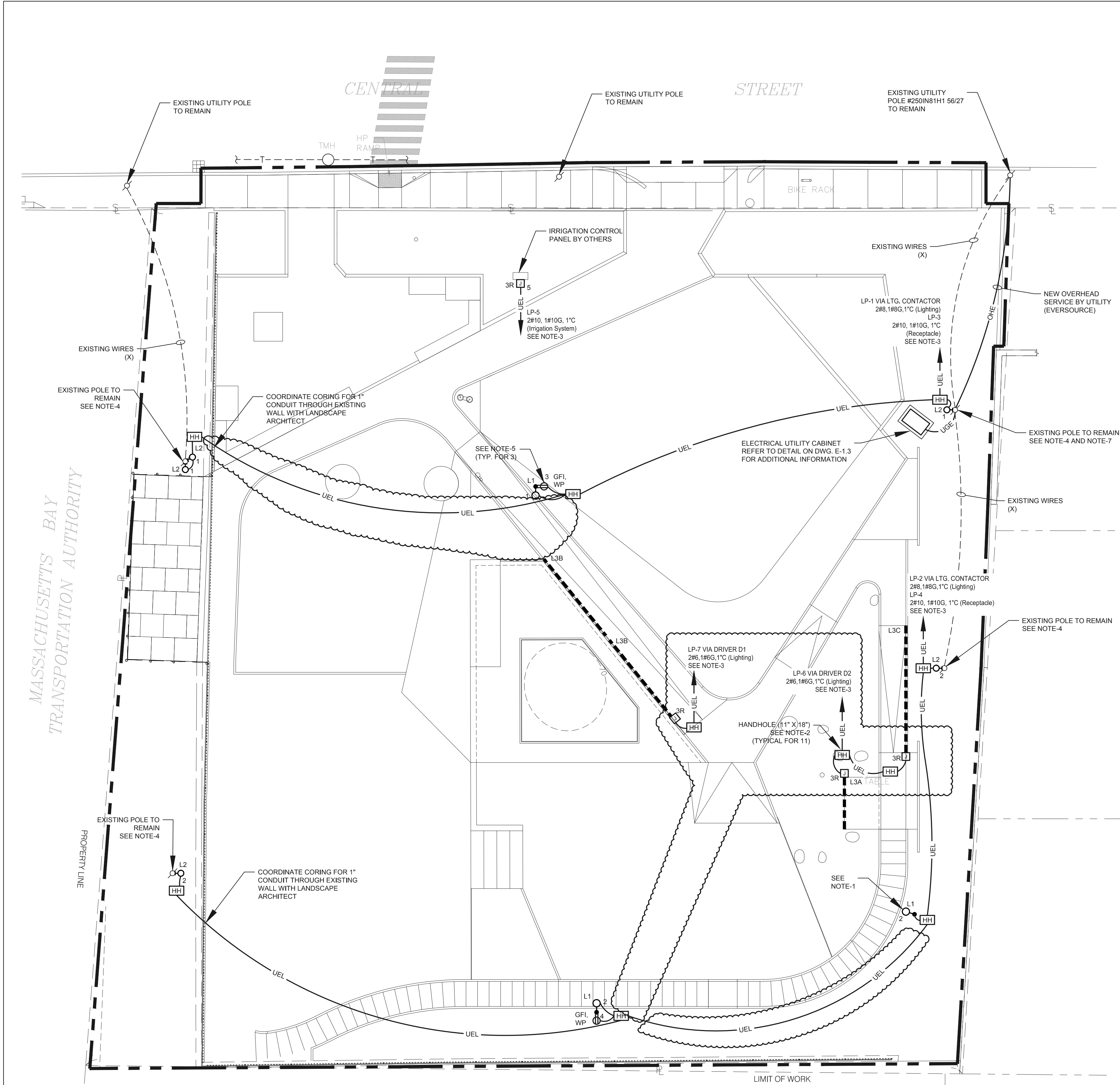

ELECTRICAL: Site Plan
SCALE: 1"=10'-0"

GENERAL DEMOLITION NOTES

(REFER TO ELECTRICAL SPECIFICATION 260000 FOR ADDITIONAL REQUIREMENTS)

1. VISIT THE SITE PRIOR TO SUBMISSION OF BID TO REVIEW THE AREAS AFFECTED BY THE PROJECT SCOPE. PROVIDE A WRITTEN REPORT TO THE OWNER/ ENGINEER DOCUMENTING ANY CONDITIONS WHICH MIGHT IMPACT COMPLETION OF THE INTENDED PROJECT SCOPE.
2. ANY/ ALL EQUIPMENT/ DEVICES DAMAGED DURING THE CONSTRUCTION EFFORT SHALL BE REPAIRED/ REPLACED BY THE CONTRACTOR.
3. EXISTING BRANCH AND FEEDER CIRCUITRY WITHIN THE PROJECT LIMITS SHALL BE TRACED AND LABELED PRIOR TO DISCONNECTION/ REMOVAL.
4. EXISTING RECEWAYS AND CONDUCTORS SCHEDULED FOR DEMOLITION SHALL BE REMOVED IN THEIR ENTIRETY FROM LOAD TO SOURCE. NO RACEWAYS AND/OR CONDUCTORS SHALL BE ABANDONED IN PLACE INCLUDING ANCILLARY COMPONENTS (e.g. JUNCTION BOXES, PULL BOXES).
5. ALL EXISTING EQUIPMENT/ DEVICES SCHEDULED FOR DEMOLITION SHALL BE OFFERED TO THE OWNER UPON DISCONNECTION/REMOVAL. THE OWNER MAY ELECT TO RETAIN SALVAGEABLE ITEMS. UNDER THIS SCENARIO, THE CONTRACTOR SHALL TURN OVER THE IDENTIFIED ITEMS AS DIRECTED BY THE OWNER. ALL OTHER ITEMS SHALL BE LEGALLY DISPOSED OF BY THE CONTRACTOR.

EXISTING EQUIPMENT DESIGNATIONS

(REFER TO GENERAL DEMOLITION NOTES)

- (X) EXISTING EQUIPMENT / DEVICE SCHEDULED TO BE REMOVED - REMOVE CIRCUIT CONDUCTORS / CONDUIT BACK TO NEXT ACTIVE DEVICE, AND/OR BACK TO SOURCE
- (XM) EXISTING EQUIPMENT / DEVICE SCHEDULED TO REMAIN
- (XR) EXISTING EQUIPMENT/DEVICE SCHEDULED TO BE RELOCATED
- (XL) EXISTING EQUIPMENT/DEVICE IN NEW LOCATION (AFTER RELOCATION)

EQUIPMENT / DEVICE LINEWEIGHT KEY

- DASHED LIGHT / OUT-OF-FUNCTION LINETYPE INDICATES EXISTING EQUIPMENT / DEVICES SCHEDULED TO BE REMOVED - (X)
- CONTINUOUS LIGHT / OUT-OF-FUNCTION LINETYPE INDICATES EXISTING EQUIPMENT / DEVICES SCHEDULED TO REMAIN, AND/OR TO BE RELOCATED - (XM), (XR), (XL)
- CONTINUOUS DARK / IN-FUNCTION LINETYPE INDICATES NEW EQUIPMENT / DEVICES

SITE LIGHTING PLAN LEGEND

- OHE OVERHEAD ELECTRIC
- UGE UNDERGROUND ELECTRIC - SECONDARY
- UEL UNDERGROUND ELECTRIC - LIGHTING
- L1 LIGHTPOLE WITH ONE (1) LUMINAIRE
UPPERCASE TEXT: INDICATES LIGHTING FIXTURE TYPE
NUMERAL: INDICATES BRANCH CIRCUIT NUMBER
- PC PHOTOCELL
- TC TIME CLOCK
- LC LIGHTING CONTACTOR
- HH ELECTRICAL HANDHOLE
- J JUNCTION BOX
- # DUPLEX RECEPTACLE - GROUNDING TYPE (NEMA 5-20R)
- NUMERAL: INDICATES BRANCH CIRCUIT NUMBER
GFI: INDICATES GROUND FAULT CIRCUIT INTERRUPTER TYPE
WP: WEATHERPROOF

GENERAL SITE PLAN NOTES:

- a) ALL TRENCHING, EXCAVATING AND BACKFILL SHALL BE PROVIDED BY THE CONTRACTOR.
- b) UNDERGROUND CONDUITS SHALL TRANSITION FROM PVC SCHEDULE 40 TO RGS UPON EXIT / ENTRY FROM FINISHED GRADE. TRANSITION FROM PVC TO RGS SHALL BE MADE UNDERGROUND.
- c) CONTRACTOR SHALL STAKE THE LOCATION OF THE FIXTURES AND HANDHOLES FOR APPROVAL FROM LANDSCAPE ARCHITECT PRIOR TO INSTALLATION.

SITE PLAN NOTES:

1. REFER TO SITE LIGHTING POLE BASE DETAIL ON DWG. E-1.3 FOR ADDITIONAL INFORMATION.
2. REFER TO PREFABRICATED HANDHOLE DETAIL ON DRAWING E-1.3 FOR ADDITIONAL INFORMATION.
3. CONDUCTORS SIZED TO ACCOMMODATE FOR VOLTAGE DROP.
4. DESIGN INTENT:
 - a) EXISTING SITE LIGHTING FIXTURE AND/OR EXISTING WIRES SCHEDULED TO BE REMOVED. NO WIRES, LIGHTS, AND/OR ACCESSORIES SHALL BE ABANDONED.
 - b) NEW LIGHTING FIXTURE SHALL BE MOUNTED ON EXISTING POLE.
5. PROVIDE TAMPER RESISTANT / GFCI RECEPTACLE HUBBELL HBL GFR5362SGW OR APPROVE EQUAL IN WEATHERPROOF LOW PROFILE METAL COVER AS MANUFACTURED BY HUBBELL TAYMAC MX4280S OR APPROVED EQUAL MOUNTED TO THE LIGHT POLE. EXACT MOUNTING HEIGHT TO BE COORDINATED WITH THE LANDSCAPE ARCHITECT.

6. NOT USED.

7. DESIGN INTENT:

- a) CONTRACTOR SHALL COORDINATE THE ESTABLISHMENT OF THE ELECTRICAL SERVICE WITH EVERSOURCE (WORK ORDER APPLICATION, EXACT ROUTING, ETC). NEW ELECTRICAL SERVICE SHALL ORIGINATE FROM THE POLE INDICATED. COORDINATE THE EXTENSION OF OVERHEAD SERVICE FROM EXISTING UTILITY POLE #250N81H1 56/27. REFER TO ELECTRICAL LOAD CALCULATION ON DRAWING E1.2 FOR ADDITIONAL INFORMATION.
- b) CONTRACTOR IS RESPONSIBLE FOR DESIGN DEPOSIT FEE TO EVERSOURCE. FOR BIDDING PURPOSES CARRY \$1500.



214 CAMBRIDGE STREET | 5TH FLOOR
BOSTON, MA 02114
t: 617.227.2560
info@klopfmartin.com

STRUCTURAL ENGINEER
DAN BONARDI CONSULTING ENGINEERS
1165R MASSACHUSETTS AVENUE, SUITE 203
ARLINGTON, MA 02476 | t: 781.483.3336

CIVIL + IRRIGATION
AQUEOUS CONSULTANTS
29 RIVER STREET
ANDOVER, MA 01810 | t: 978.809.6420

ELECTRICAL
AVID ENGINEERS
344 BOYLSTON STREET - 3RD FLOOR
BOSTON, MA 02116 | t: 978.663.5580

CLIENT:
CITY OF SOMERVILLE,
MASSACHUSETTS

DIRECTOR OF PARKS AND OPEN SPACE
ARN FRANZEN
t: 617.625.6600x2545
afranzen@somervillema.gov

REVISIONS:

REV	DATE	NOTE
1	02/23/17	ELECTRICAL REVISIONS

PROJECT: KMDG #1604

HOYT SULLIVAN
PLAYGROUND

117 CENTRAL STREET
SOMERVILLE, MA 02145

DRAWING:

ELECTRICAL
SITE PLAN

DRAWN: REVIEW:
EP AMA

SCALE:
1" = 10'-0"

DATE:
16 FEBRUARY 2017

SHEET:

E1.1

SCHEDULE OF PANELBOARDS																																					
PANEL	VOLTAGE	PHASE	WIRE	BUS	MCB	MLO	AIC	TOTAL POLES	MOUNTING	1-POLE					2-POLE BRANCH CIRCUIT BREAKERS						3-POLE BRANCH CIRCUIT BREAKERS										NOTES						
										15A	20A	30A	40A	50A	15A	20A	25A	30A	40A	50A	60A	15A	20A	25A	30A	40A	50A	60A	70A	80A		90A	100A	125A	150A	175A	200A
LP	120/240V	1	3	60A	60A	---	22K	10	SURFACE		10																										NOTE-11
<div>GENERAL NOTES (applicable to all panelboards):</div> <div>a) PROVIDE MECHANICAL TERMINAL LUGS TO ACCOMMODATE FEEDER CIRCUITRY AS LISTED ON THE ONE-LINE POWER DIAGRAM FOR ALL TERMINATIONS.</div> <div>b) PANELBOARDS SHALL BE FULLY RATED.</div>										<div>SCHEDULE OF PANELBOARDS ABBREVIATION KEY:</div> <div>MCB - MAIN CIRCUIT BREAKER</div> <div>MLO - MAIN LUG ONLY</div> <div>AIC - MINIMUM INTERRUPTING RATING OF CIRCUIT BREAKERS</div> <div>GFCI - GROUND FAULT CIRCUIT INTERRUPTER</div> <div>AFCI - ARC FAULT CIRCUIT INTERRUPTER</div>										<div>SCHEDULE OF PANELBOARDS NOTES (as specifically indicated above):</div> <div>1. PROVIDE PANELBOARD WITH FEED-THROUGH LUGS.</div> <div>2. PROVIDE PANELBOARD WITH ISOLATED GROUND BUS.</div> <div>3. PROVIDE PANELBOARD WITH 200% RATED NEUTRAL BUS.</div> <div>4. PROVIDE PANELBOARD WITH TRANSIENT VOLTAGE SURGE SUPPRESSION (TVSS).</div> <div>5. PROVIDE CIRCUIT BREAKER WITH SHUNT TRIP AUXILIARY ATTACHMENT.</div> <div>6. BRANCH CIRCUIT BREAKER SHALL BE GFCI TYPE RATED 4.8 ma for PROTECTION OF PERSONNEL.</div> <div>7. BRANCH CIRCUIT BREAKER SHALL BE GFCI TYPE RATED 30 ma for PROTECTION OF EQUIPMENT.</div> <div>8. BRANCH CIRCUIT BREAKER SHALL BE AFCI TYPE.</div> <div>9. PROVIDE (1) 20A-1P, 120V CIRCUIT BREAKER WITH LOCKABLE HANDLE.</div> <div>10. PROVIDE NEMA 3R ENCLOSURE TYPE.</div> <div>11. PANELBOARD SHALL BE UL-LISTED SE-RATED SUITABLE FOR SERVICE ENTRANCE APPLICATIONS.</div>																	

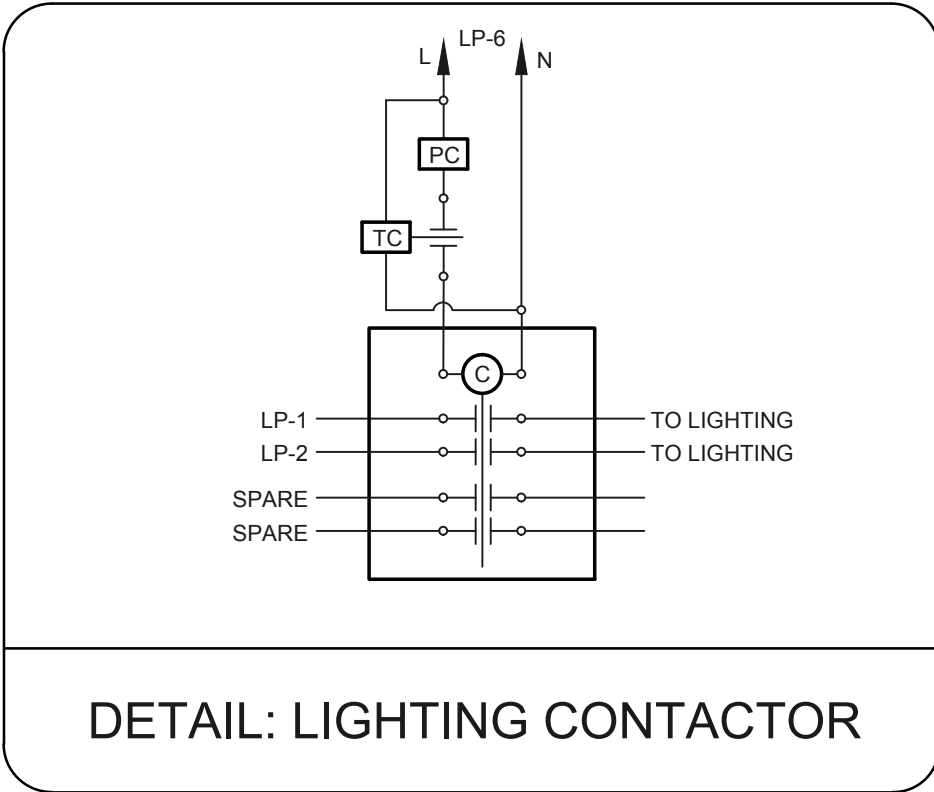

DETAIL: LIGHTING CONTACTOR

SCHEDULE OF LIGHTING FIXTURES											
TYPE	MANUFACTURER	CATALOG NUMBER	DESCRIPTION	LAMP DATA		BALLAST DATA		VOLTAGE	WATTS	MOUNTING	NOTES
				NO.	TYPE	NO.	TYPE				
L1	WE-EF LIGHTING	ASPSHALED 655-3520 WITH 655-9370 (LUMINAIRE) 693-1223 (POLE)	SITE LIGHTING LED FIXTURE TYPE III MEDIUM	-	28W LED ARRAY	-	---	120V	28 W	12'-0" ON NEW POLE	NOTES-1, 2, 3, 4
L2	WE-EF LIGHTING	FLC141LED 655-7426 WITH J81 JUNCTION BOX	SURFACE MOUNTED LED FIXTURE	-	55W LED ARRAY	-	---	120V	55 W	20'-0" ON EXISTING POLE	NOTES-1, 2, 3, 4
L3A	OPTIC ARTS LIGHTING	FLEX DC 22-68-30 WITH CHW-SH-7532 MOUNTING CHANNELS GG100E-24-UNV DRIVER	SURFACE MOUNTED FLEXIBLE LED TAPE FIXTURE 9'-0"	-	2.2W/FT LED TAPE	-	---	120V	20 W	SURFACE	NOTES-1, 2, 3, 4, 5
L3B	OPTIC ARTS LIGHTING	FLEX DC 22-68-30 WITH CHW-SH-7532 MOUNTING CHANNELS GG100E-24-UNV DRIVER	SURFACE MOUNTED FLEXIBLE LED TAPE FIXTURE 17'-6"	-	2.2W/FT LED TAPE	-	---	120V	40 W	SURFACE	NOTES-1, 2, 3, 4, 5
L3C	OPTIC ARTS LIGHTING	FLEX DC 22-68-30 WITH CHW-SH-7532 MOUNTING CHANNELS GG100E-24-UNV DRIVER	SURFACE MOUNTED FLEXIBLE LED TAPE FIXTURE 20'-0"	-	2.2W/FT LED TAPE	-	---	120V	44 W	SURFACE	NOTES-1, 2, 3, 4, 5
<div>SCHEDULE OF LIGHTING FIXTURE NOTES (as specifically indicated above):</div> <div>1. FIXTURE AND ASSOCIATED ACCESSORIES SHALL BE UL-LISTED WET LOCATION FOR INSTALLATION IN WET/EXTERIOR ENVIRONMENTS. COORDINATE EXACT LOCATION, MOUNTING HEIGHT AND LIGHTING FIXTURE AIMING IN FIELD WITH LANDSCAPE ARCHITECT.</div> <div>2. COORDINATE FINISH/COLOR WITH LANDSCAPE ARCHITECT.</div> <div>3. COORDINATE EXACT LOCATION OF LED TAPE AND NEMA 3R JUNCTION BOX IN THE FIELD WITH LANDSCAPE ARCHITECT PRIOR TO ROUGH-IN. LED TAPE LENGTH IS APPROXIMATE. ADJUST IN FIELD AS NECESSARY.</div> <div>4. LOCAL LIGHTING REFERENCE FOR WE-EF AND OPTIC ARTS LIGHTING: BOSTON LIGHT SOURCE, CONTACT AUSTIN YOUNG: ayoung@bostonlightsource.com, 617-786-4211.</div> <div>5. PROVIDE MODIFIED CHANNEL BY OPTIC ARTS TO ALLOW SPACE FOR SECOND SET OF LEADER WIRES.</div>											
<div>GENERAL NOTES (for all lighting fixtures):</div> <div>a) LIGHTING FIXTURES LISTED ABOVE ESTABLISH THE PROPOSED LEVEL OF QUALITY. ANY/ALL PROPOSED LIGHTING FIXTURE SUBSTITUTIONS SHALL BE AN APPROVED EQUAL.</div> <div>b) PROVIDE ALL ACCESSORIES AND HARDWARE TO ACCOMMODATE MOUNTING REQUIREMENTS.</div>											

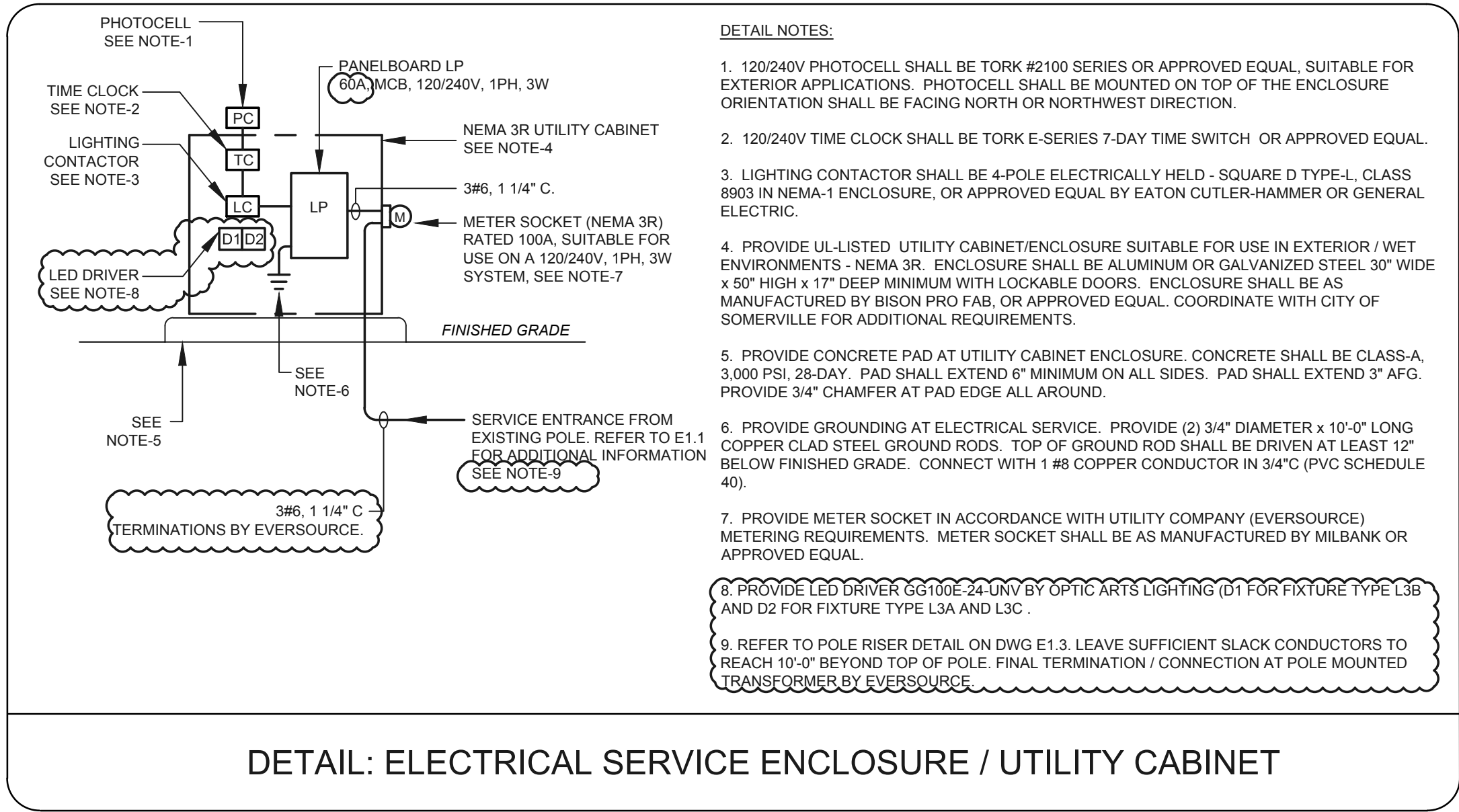

DETAIL: ELECTRICAL SERVICE ENCLOSURE / UTILITY CABINET

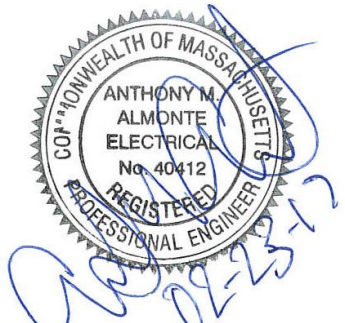

214 CAMBRIDGE STREET | 5TH FLOOR
BOSTON, MA 02114
t: 617.227.2560
info@klopfermartin.com

STRUCTURAL ENGINEER
DAN BONARDI CONSULTING ENGINEERS
1165R MASSACHUSETTS AVENUE, SUITE 203
ARLINGTON, MA 02476 | t: 781.483.3336

CIVIL + IRRIGATION
AQUEOUS CONSULTANTS
29 RIVER STREET
ANDOVER, MA 01810 | t: 978.809.6420

ELECTRICAL
AVID ENGINEERS
344 BOYLSTON STREET - 3RD FLOOR
BOSTON, MA 02116 | t: 978.663.5580

CLIENT:
CITY OF SOMERVILLE,
MASSACHUSETTS
DIRECTOR OF PARKS AND OPEN SPACE
ARN FRANZEN
t: 617.625.6600x2545
afranzen@somervillema.gov

REVISIONS:		
REV	DATE	NOTE
1	02/23/17	ELECTRICAL REVISIONS

PROJECT: KMDG #1604

HOYT SULLIVAN
PLAYGROUND

117 CENTRAL STREET
SOMERVILLE, MA 02145

DRAWING:

ELECTRICAL
SCHEDULE SHEET

DRAWN: REVIEW:
EP AMA

SCALE:
N.T.S.

DATE:
16 FEBRUARY 2017

SHEET:

E1.2